

GP4012FF

PN: BTVACDTOLTDFFCN01B

EAN: 6422956010126

Specifications

Battery Model	GP4012FF
Voltage	12V
Power (1,65V/cell@15 min)	123.88W/cell
Type	VRLA - maintenance free
Designed Floating Life	3~5 years
Nominal Operating Temp. Range	25°C ± 3°C
Terminal	T6
Construction	
Container & Cover	ABS
Safety valve	Rubber
Terminal	Copper
Internal Resistance	Full charged at 25°C ≤ 10mΩ
Self Discharge (20°C)	2% of capacity declined per month
Capacity affected by temperature	
40°C	103%
25°C	100%
0°C	86%
Charge Voltage (25°C)	
Cycle use	14.4V - 15.0V (-30mV/°C), max. Current: 12A
Float use	13.5V - 13.8V (-20mV/°C)
Physical	
Without Terminal	196 x 165 x 175 mm
With Terminal	196 x 165 x 176 mm
Product Weight	11.5 Kg



Completely sealed and maintenance-free



Excellent charging and re-charging



Floating & standby use: 3-5 years

- Small size battery
- Excellent charging and re-charging
- Stable and reliable for long-term
- Low self-discharge
- Floating & standby use: 3-5 years
- More than 260 cycles at 100% DOD
- Multiple Application: Alarm and Security Systems, Cable Television, Communication Equipment, Power Tools, Control Equipment, Medical Equipment, UPS, Toys

Dimensions (mm)

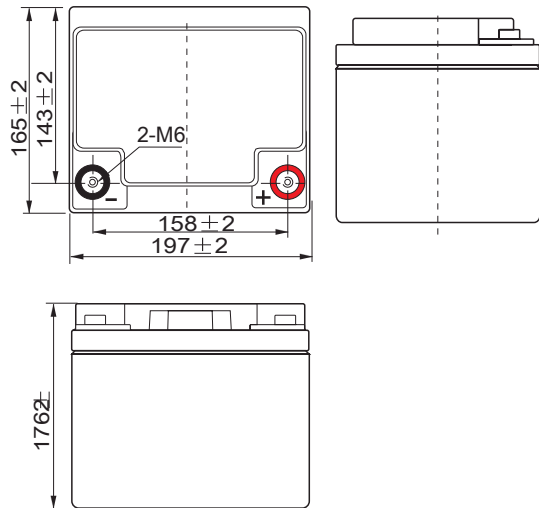

T6 Terminal Dimensions (mm)

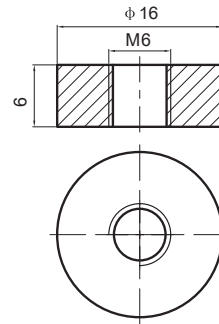

Float Charging Characteristics

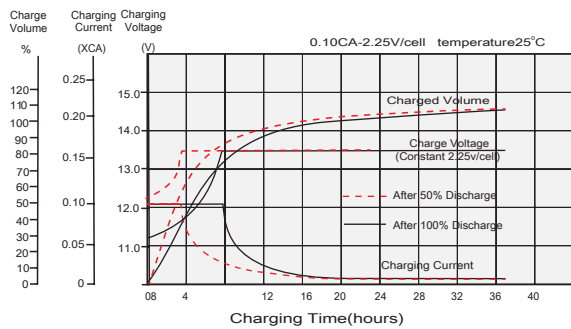

Discharge Characteristics

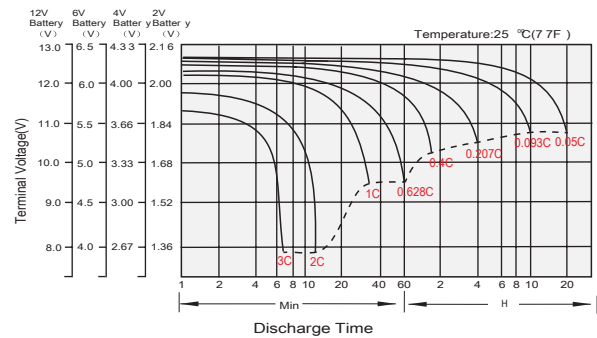

Temperature Effects in Relation to Battery Capacity

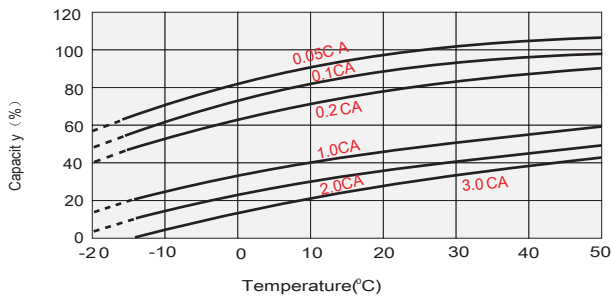

Effect of Temperature on Long Term Float Life

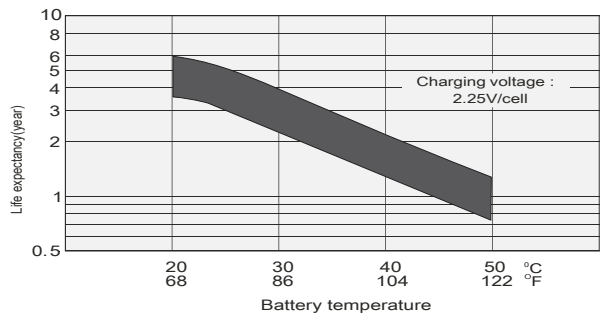

Cycle Life in Relation to Depth of Discharge

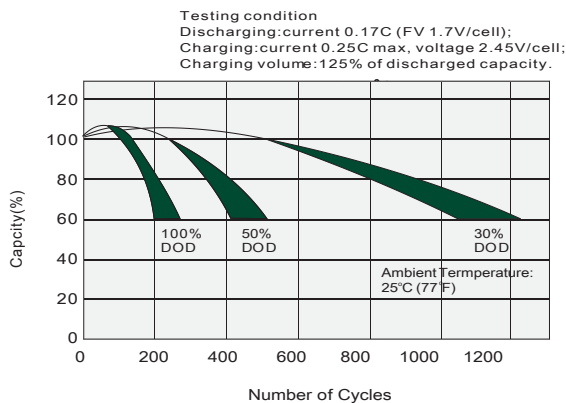

Self Discharge Characteristics

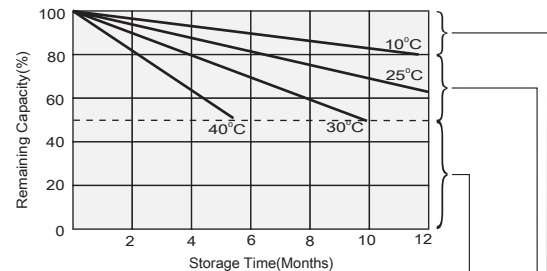

Supplemental charge may often fail to recover the capacity. The battery should never be left standing until this is reached.

Supplemental charge required before use. Optimal charging way as below:
 1. Charged for above 3 days at limited current 0.25CA and constant voltage 2.25V/cell.
 2. Charged for above 20 hours at limited current 0.25CA and constant voltage 2.45V/cell.
 3. Charged for 8-10 hours at limited current 0.05CA.

No supplemental charge required
 (Carry out supplemental charge before use if 100% capacity is required.)





Constant Current Discharge Characteristics (A), 25°C

F.V/Ti	5min	10min	15min	30min	1Hr	3Hr	5Hr	10Hr	20Hr
1.80V/cell	102.873	82.718	59.863	44.311	22.762	10.400	7.153	3.933	2.123
1.75V/cell	105.805	85.707	61.071	45.171	23.661	10.755	7.313	4.001	2.151
1.70V/cell	113.136	90.913	63.487	45.816	23.756	10.863	7.430	4.085	2.205
1.65V/cell	116.190	92.744	65.098	46.247	23.874	11.024	7.569	4.185	2.280
1.60V/cell	122.177	96.408	67.111	40.869	24.040	11.293	7.825	4.361	2.366



Constant Wattage Discharge Characteristics (W), 25°C

F.V/Ti	5min	10min	15min	30min	1Hr	3Hr	5Hr	10Hr	20Hr
1.80V/cell	183.628	149.802	110.627	82.240	42.405	19.500	13.568	7.724	4.185
1.75V/cell	192.142	156.500	113.898	84.876	44.530	20.327	13.998	7.922	4.278
1.70V/cell	207.378	168.006	119.419	86.822	45.350	20.824	14.400	8.186	4.421
1.65V/cell	214.371	172.597	123.881	88.608	43.618	21.342	14.806	8.491	4.644
1.60V/cell	226.271	180.765	128.518	78.959	46.829	22.043	15.416	8.944	4.884



Logistics

	Carton Box Size	210 x 175 x 196 mm
	Pieces in the Carton Box	1 pc / ctn
	Net & Gross weight / CTN	N.W. / G.W.: 11.5 kg / 11.8 kg



Certificates

